

1. HOUSING: THERMOPLASTIC (UL 94V-0).
2. COVER: THERMOPLASTIC (UL 94V-0).
3. TERMINAL: COPPER ALLOY,
GOLD PLATED ON CONTACT AREA,
TIN PLATED ON SOLDER TAILS,
NICKEL UNDER PLATED OVERALL.
4. BOARD LOCK: SPCC, TIN PLATED OVER NICKEL.
5. SHELL: SPCC, NICKEL PLATED OVERALL.
6. RIVET: Zn ALLOY, NICKEL PLATED OVERALL.
1. MATING FORCE: 4.5KG/MAX.
2. UNMATING FORCE: 1.0-4.0KG.
3. DIELECTRIC WITHSTANDING VOLTAGE:
500V AC R.M.S. FOR ONE MINUTE.
4. INSULATION RESISTANCE:
1000MΩ MIN AT 500V DC.
5. CONTACT RESISTANCE: 30mΩ MAX.
6. OPERATING TEMPERATURE : -25°C TO +85°C.

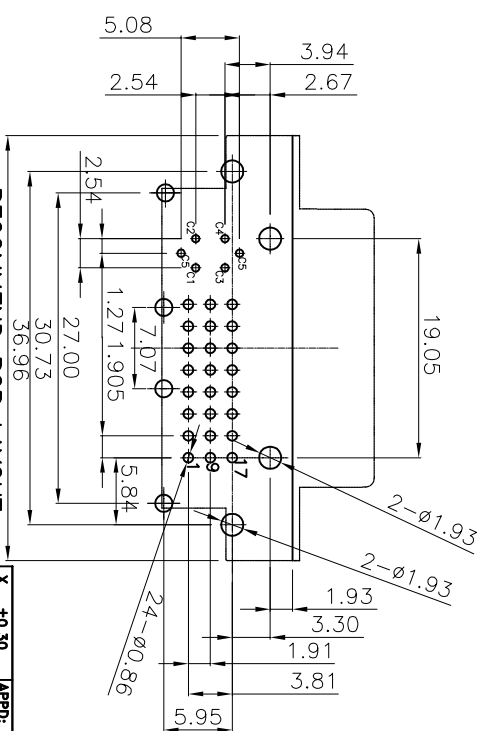
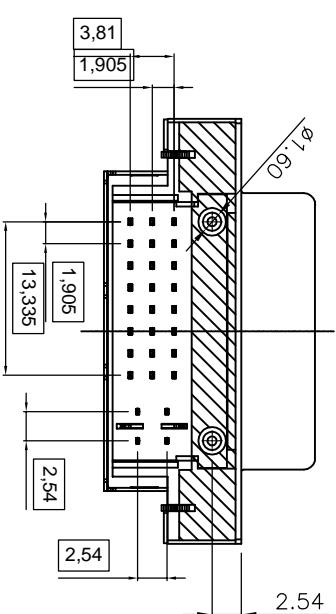

RECOMMEND PCB LAYOUT
TOLERANCE: ±0.05
TOP VIEW

REV	ECN NO	DESCRIPTION	DATE
A	JLIONS-DVI-0005		2011/02/01

Jions 北京玖思启明电子科技有限公司

X. ± 0.50		APPD:	TITLE:	
X. ± 0.20		Mr. WU	29PIN 焊板式 母头+后铁壳	
XX ± 0.10		CHKD:	+B型铜箔	
.XXX ± 0.05		Mr. WU	PART NO: JIONS-0032	
X' $\pm 2^{\circ}$		DR:	DWG NO:	
X' $\pm 1^{\circ}$		Gas cheng	客户图	
UNITS:		SCALE:	SHEET:10H1	
mm		1:1	REV:	
