

1. HOUSING: THERMOPLASTIC (UL 94V-0).
 2. COVER: THERMOPLASTIC (UL 94V-0).
 3. TERMINAL: COPPER ALLOY,
GOLD PLATED ON CONTACT AREA,
TIN PLATED ON SOLDER TAILS,
NICKEL UNDER PLATED OVERALL.
 4. BOARD LOCK: SPCC, TIN PLATED OVER NICKEL.
 5. SHELL: SPCC, NICKEL PLATED OVERALL.
 6. RIVET: Zn ALLOY, NICKEL PLATED OVERALL.
1. MATING FORCE: 4.5KG/MAX.
 2. UNMATING FORCE: 1.0-4.0KG.
 3. DIELECTRIC WITHSTANDING VOLTAGE:
500V AC R.M.S. FOR ONE MINUTE.
 4. INSULATION RESISTANCE:
1000MΩ MIN AT 500V DC.
 5. CONTACT RESISTANCE: 30mΩ MAX.
 6. OPERATING TEMPERATURE : -25°C TO +85°C.

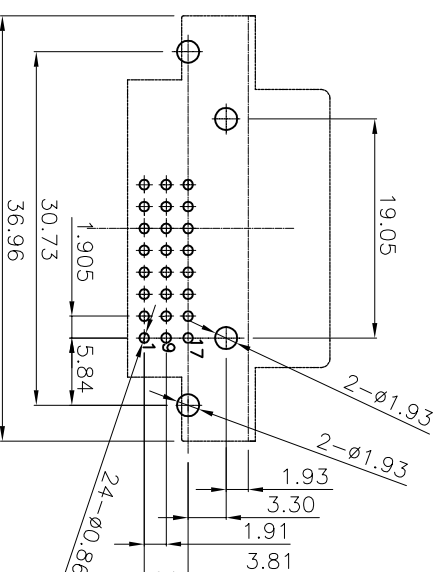
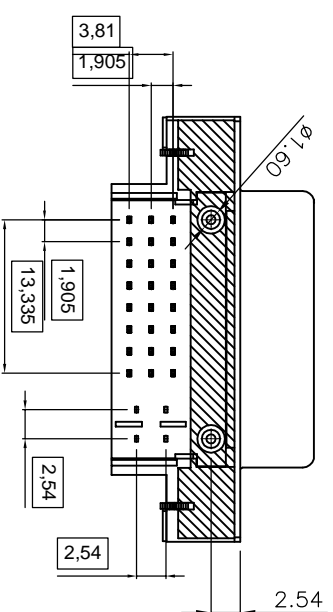

RECOMMEND PCB LAYOUT
TOLERANCE: ±0.05
TOP VIEW

X: ±0.30	APPD: Mr.WU	TITLE:
X: ±0.20	CHKD: Mr.WU	24PIN 焊板式 母头+B型铜箔
XX: ±0.10	DR: Gus chong	PART NO: JIONS-0035
XXX: ±0.05	UNITS: mm	DWG NO: WWW.JIONS.COM.CN
X' ±1'	SCALE: 1:1	SHEET: 10/1

REV	ECN NO	DESCRIPTION	DATE
A	JIONS-DVL-0008		2011/02/01

Jions 北京玖盟启明电子科技有限公司